

SITE PLAN
Scale : 1:500

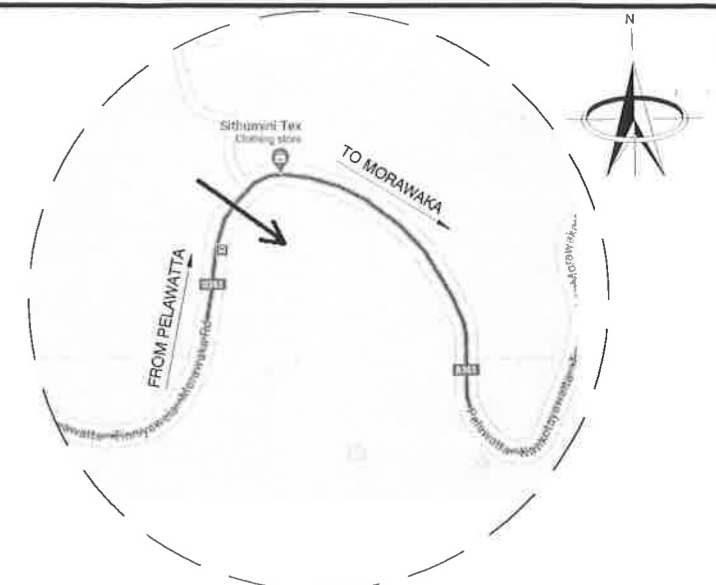

LOCATION MAP
(Not scale)

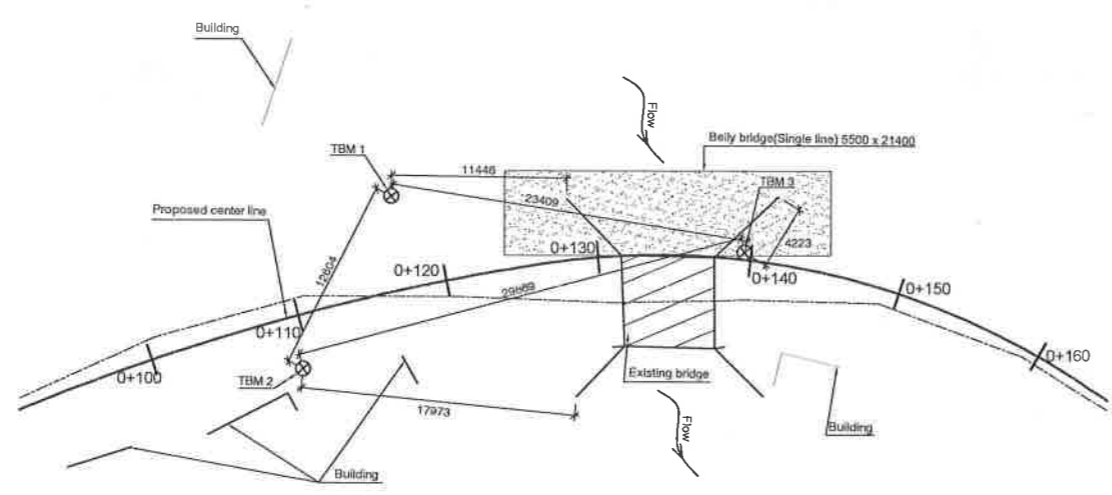

KEY DIAGRAM FOR REFERENCE POINTS
Scale : 1:250

83.6

CO-ORDINATES FOR SETTING OUT OF NEW CENTER LINE

CHANGE	CO-ORDINATES (m)	
	E	N
0+000	970.3440	879.5490
0+010	972.4040	889.3345
0+020	974.4639	899.1201
0+030	976.5239	908.9056
0+040	978.5838	918.6911
0+050	980.6438	928.4767
0+060	982.7037	938.2622
0+070	984.7637	948.0477
0+080	986.8236	957.8332
0+090	988.8835	967.6187
0+100	992.7203	976.9322
0+110	996.5571	986.2457
0+120	1001.0855	995.0917
0+130	1006.2041	1003.6643
0+134	1008.8398	1006.8471
0+140	1012.7316	1011.2184
0+150	1020.6197	1017.3381
0+160	1029.5591	1021.7832
0+170	1039.1992	1024.3794
0+180	1049.1620	1025.0249
0+190	1059.0565	1023.6945
0+200	1068.5211	1020.5028
0+210	1077.8103	1018.8001
0+220	1087.0996	1013.0975
0+228	1094.7000	1010.0680

NOTE : Setting out of bridge and approaches to be done simultaneously and shall be referred to the engineer prior to foundation excavation.

CO-ORDINATES FOR REFERENCE POINTS

	CO-ORDINATES (m)		REDUCED LEVEL (M)
	X-EASTING	Y-NORTHING	
T.B.M.1	994.5420	995.5870	101.112
T.B.M.2	999.4830	983.9920	100.657
T.B.M.3	1012.1060	1011.0630	99.656

TENDER ISSUE
NOT FOR CONSTRUCTION

PELAWATTA - KANKOTIYAWATTA - THINIYAWALA - MORAWAKA ROAD. (B 363)
BRIDGE NO: 9/1 km (RE-CONSTRUCTION)

SITE PLAN

REV.	DESCRIPTION	BY	DATE

MINISTRY OF HIGHWAYS - SRI LANKA ROAD DEVELOPMENT AUTHORITY		 BRIDGE DESIGNS OFFICE *MAGANEGUMA MAHAMEDURAJA* BATTARAMULLA
DESIGNED : <i>K.K.D.N.J. Panawesera</i> DRAWN : <i>Suranoo Pradeep</i> CHECKED : FILE NO. : <i>WP-90</i> DRG. NO. <i>WP/B/1494/1</i>	SENIOR ENGINEER - DESIGNS ADDITIONAL DIRECTOR - BRIDGE DESIGNS	
DATE:		8

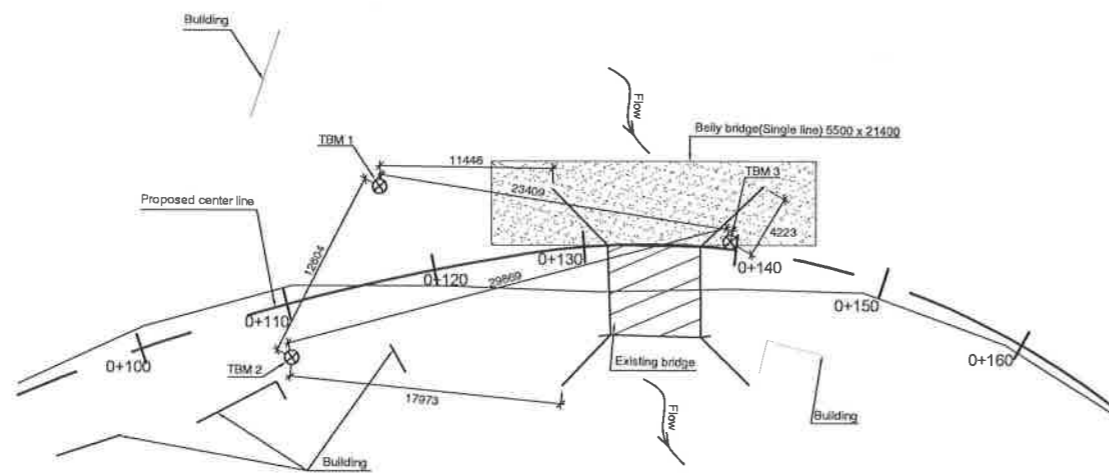
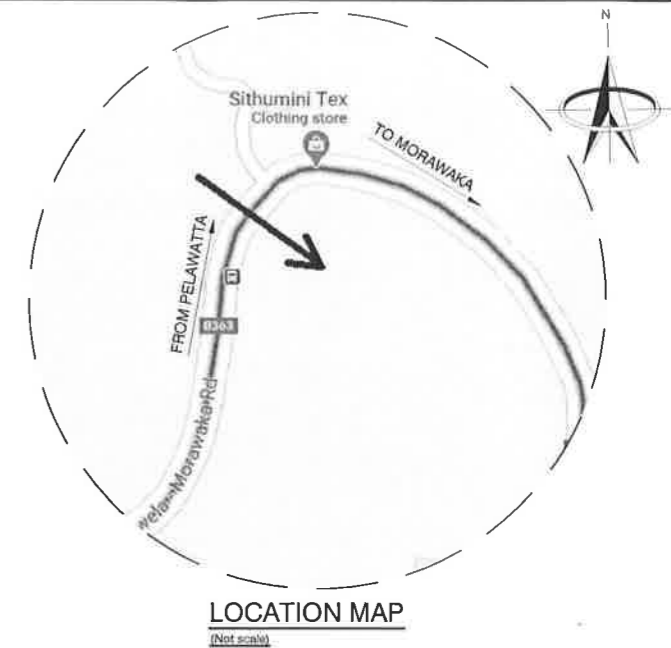
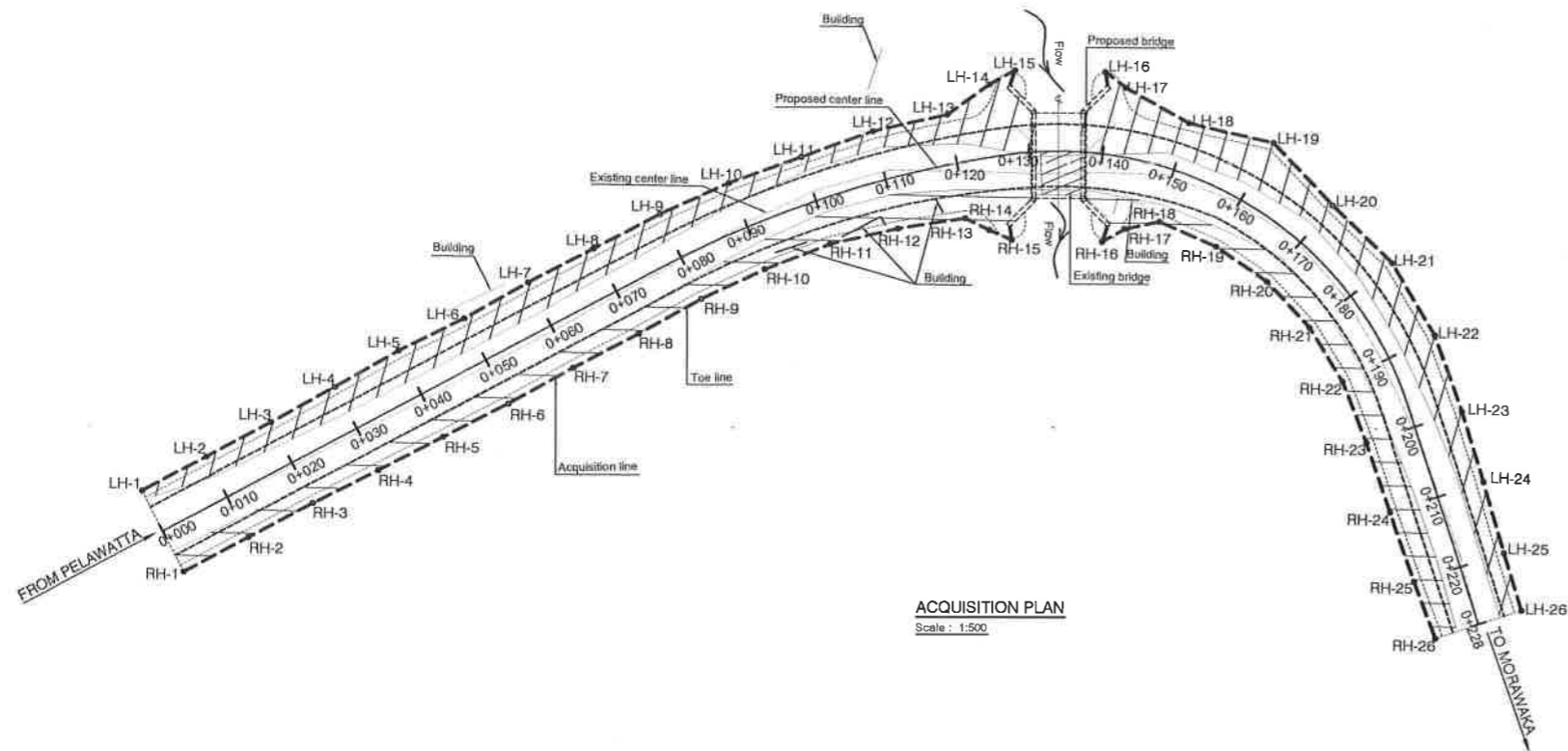

CO-ORDINATES FOR ACQUISITION LINE			CO-ORDINATES FOR ACQUISITION LINE		
SIDE	CO-ORDINATE		SIDE	CO-ORDINATE	
	North (m)	East (m)		North (m)	East (m)
LH-1	880.8338	964.2479	RH-1	878.2704	978.4107
LH-2	890.8123	988.337	RH-2	888.0559	978.4706
LH-3	900.388	988.3845	RH-3	897.8322	980.5287
LH-4	910.199	970.2581	RH-4	907.5723	982.771
LH-5	920.0876	972.0477	RH-5	917.3304	984.9873
LH-6	929.7875	974.4196	RH-6	927.0886	987.1904
LH-7	939.8222	978.2083	RH-7	936.8315	989.0909
LH-8	949.3788	978.3421	RH-8	946.7125	991.1373
LH-9	959.3382	980.5001	RH-9	956.3882	992.9882
LH-10	969.394	983.2816	RH-10	965.8536	995.4315
LH-11	979.1858	986.7903	RH-11	974.8912	998.5035
LH-12	989.0275	990.4133	RH-12	983.2285	1002.8085
LH-13	998.3313	995.1293	RH-13	991.2148	1007.587
LH-14	1005.4155	995.8322	RH-14	992.8997	1010.8035
LH-15	1008.3118	998.3346	RH-15	994.2089	1013.8882
LH-16	1018.8474	1004.3891	RH-16	1003.5428	1021.8205
LH-17	1018.4389	1007.8402	RH-17	1007.1008	1022.5874
LH-18	1022.9974	1017.0814	RH-18	1011.2897	1024.8277
LH-19	1030.1544	1026.3964	RH-19	1015.1224	1032.3437
LH-20	1030.9543	1038.1031	RH-20	1017.4484	1040.3734
LH-21	1032.2473	1049.4085	RH-21	1017.8331	1048.9185
LH-22	1030.4583	1060.8522	RH-22	1018.7894	1057.409
LH-23	1028.7381	1071.001	RH-23	1013.8986	1065.9738
LH-24	1022.8182	1080.2863	RH-24	1010.4535	1075.305
LH-25	1018.8596	1089.4582	RH-25	1007.0141	1084.7125
LH-26	1015.8203	1097.009	RH-26	1004.2929	1082.4422

Total area to be acquired=1999.22 sq.m

CO-ORDINATES FOR REFERENCE POINTS			
	CO-ORDINATES/(m)		REDUCED LEVEL (M)
	X-EASTING	Y-NORTHING	
T.B.M.1	994.5420	995.5870	101.112
T.B.M.2	999.4830	983.9920	100.657
T.B.M.3	1012.1080	1011.0830	99.956

Note :-

- Setting out of bridge and approaches to be done simultaneously and shall be referred to the engineer prior to foundation excavation.
- Bridge approaches to be smoothly merged with the existing carriage way.

PELAWATTA - KANKOTIYAWATTA - THINIYAWALA - MORAWAKA ROAD. (B 363)
BRIDGE NO: 9/1 km (RE-CONSTRUCTION)

ACQUISITION PLAN

REV.	DESCRIPTION	BY	DATE

MINISTRY OF HIGHWAYS - SRI LANKA
ROAD DEVELOPMENT AUTHORITY

DESIGNED : K.K.D.N.J. Ranasuera	SENIOR ENGINEER - DESIGNS	DEPUTY DIRECTOR GENERAL (S.D.)
DRAWN : Suranga Pradeep		
CHECKED :	ADDITIONAL DIRECTOR - BRIDGE DESIGNS	ADDITIONAL DIRECTOR GENERAL (E.S.) FOR DIRECTOR GENERAL
FILE NO. : WP-00	DRG. NO. WP/B/1494/1A	DATE :

BRIDGE DESIGNS OFFICE
MAGANEGUMA MAHAMEDURU
BATTARAMULLA

TENDER ISSUE
NOT FOR CONSTRUCTION

FROM PELAWATTA

TO MORAWAKA

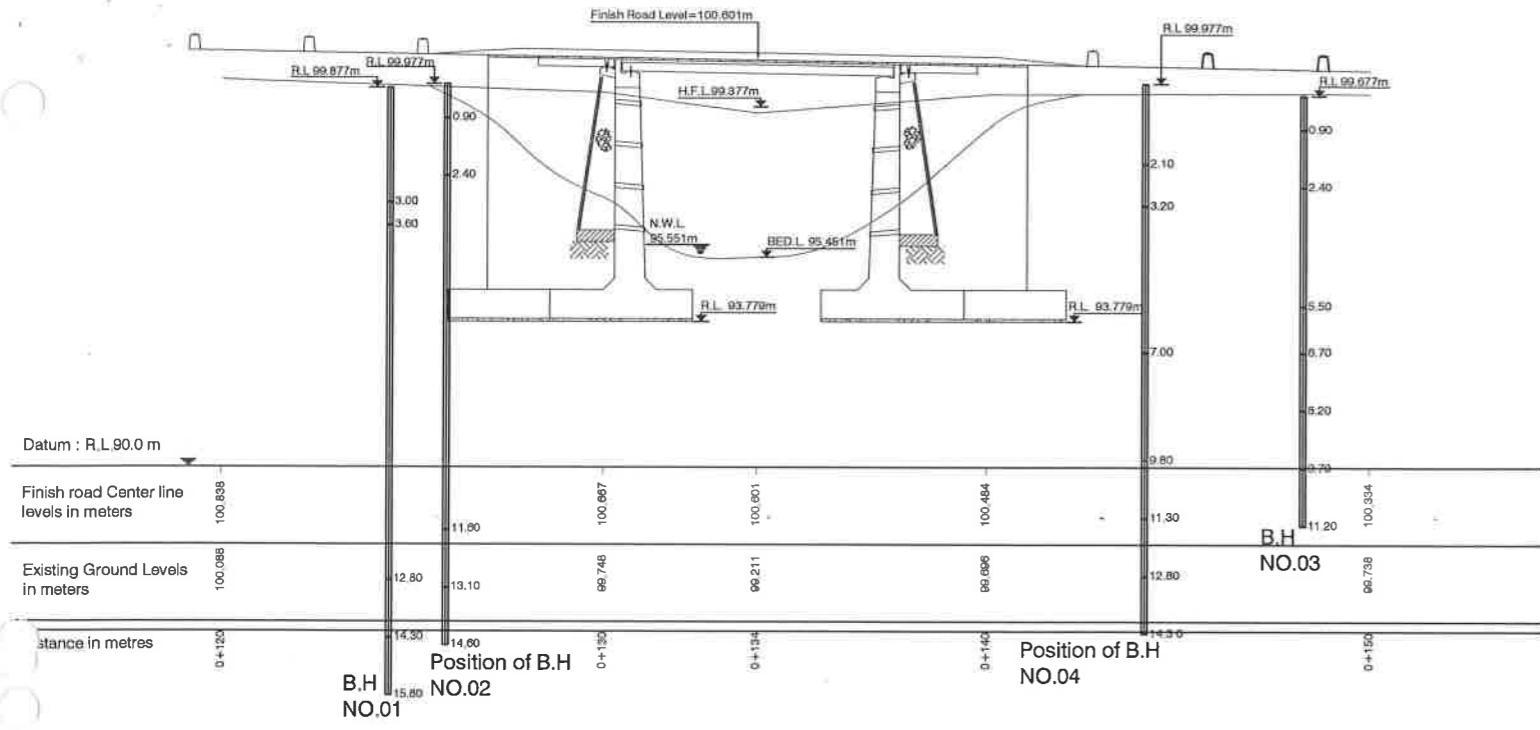

LONGITUDINAL SECTION
Scale = 1:100

BORE HOLE No. 01					
DATE OF BORING : 12.02.2021					
R.L. ON TOP OF BORE HOLE 99.877m					
DESCRIPTION OF MATERIAL	LEGEND	DEPTH IN METERS	S.P.T. VALUES DEPTH & THICKNESS IN METERS	No. OF BLOWS	REMARKS
Clayey Sand with gravel. (Yellowish brown)		0.00 - 1.85		SPT - 03	Ground Elevation on existing bridge deck top level. Ground Water level - 3.8 m.
		1.85 - 3.00		Rebonded	
Boulder		3.00 - 4.50		Rebonded	
Highly weathered Rock		4.50 - 12.80			
Bed Rock.		12.80 - 14.30			T.C.R - 90% R.Q.D - 85% F.L. - 8-9 rpm
Bed Rock.		14.30 - 15.80	S _{2020/2574}		T.C.R - 96% R.Q.D - 80% F.L. - 3-4 rpm
			UCS - 9160 psi		

BORE HOLE No. 02					
DATE OF BORING : 12.02.2021					
R.L. ON TOP OF BORE HOLE 99.877m					
DESCRIPTION OF MATERIAL	LEGEND	DEPTH IN METERS	S.P.T. VALUES DEPTH & THICKNESS IN METERS	No. OF BLOWS	REMARKS
Clayey Sand (Brownish red)		0.00 - 1.85		SPT - 35	Ground Elevation on existing bridge deck top level. Ground Water level - 4.2 m.
Coarse to medium sand with silty clay and gravel. (yellowish brown)		1.85 - 3.00		Rebonded	
		3.00 - 4.50		Rebonded	
Highly weathered Rock		4.50 - 11.80			
Bed Rock.		11.80 - 13.10			T.C.R - 83% R.Q.D - 43% F.L. - Highly
Bed Rock.		13.10 - 14.80	S _{2020/2574}		T.C.R - 100% R.Q.D - 98% F.L. - 2-3 rpm
			UCS - 21890 psi		

LEGEND

- Rock
 - Soil
 - Rubble
 - Gravel
 - Clay
 - Bed rock.
 - Concrete slab
 - Weathered rock.
 - Sand
 - Inorganic silt
 - Boulder
 - Decomposed rock.
 - Mica.
 - Silt.
 - Peat.
 - Sand rock.
 - Soft rock.
 - pebbles
 - Aggregate
- C.R. - Core Recovery
R.Q.D. - Rock quality Designation
S.P.T. - Standard penetration Test (SPT)
F.L. - Fracture Index.

NOTE :
All dimensions are in meters unless otherwise stated.

BORE HOLE No. 03					
DATE OF BORING : 12.02.2021					
R.L. ON TOP OF BORE HOLE 99.877m					
DESCRIPTION OF MATERIAL	LEGEND	DEPTH IN METERS	S.P.T. VALUES DEPTH & THICKNESS IN METERS	No. OF BLOWS	REMARKS
Clayey Sand with gravel (Yellowish brown)		0.00 - 1.85		SPT - 32	Ground elevation on existing bridge deck top level.
Coarse to medium sand with gravel. (Yellowish brown)		1.85 - 2.40			
Medium to fine Sand with little amount of mica (brownish yellow)		2.40 - 3.15		SPT - 17	Ground water Level 4.7m.
		3.15 - 4.05		SPT - 13	
		4.05 - 5.50			
Highly weathered Rock		5.50 - 6.10			10/0.10m for 1st 0.15m No further penetration
Bed Rock.		6.10 - 8.20			T.C.R - 73% R.Q.D - 09% F.L. - Highly.
Bed Rock.		8.20 - 9.70			T.C.R - 87% R.Q.D - 40% F.L. - Highly.
Bed Rock.		9.70 - 11.20	S _{2020/2575}		T.C.R - 94% R.Q.D - 78% F.L. - 4-5 rpm.
			UCS - 9550 psi		

BORE HOLE No. 04					
DATE OF BORING : 12.02.2021					
R.L. ON TOP OF BORE HOLE 99.877m					
DESCRIPTION OF MATERIAL	LEGEND	DEPTH IN METERS	S.P.T. VALUES DEPTH & THICKNESS IN METERS	No. OF BLOWS	REMARKS
Clayey Sand with Gravel. (Reddish brown)		0.00 - 1.85		SPT - 18	Ground elevation on existing bridge deck top level.
Coarse to medium sand with gravel. (Yellowish brown)		1.85 - 3.20		SPT - 08	
		3.20 - 4.05		SPT - 13	Ground water Level 5.2m.
Silty sand with little amount of clay (Yellowish brown)		4.05 - 6.15		SPT - 27	
		6.15 - 7.00			
Highly weathered Rock		7.00 - 9.80			
Bed Rock.		9.80 - 11.30			T.C.R - 80% R.Q.D - Nil F.L. - Highly.
Bed Rock.		11.30 - 12.80			T.C.R - 89% R.Q.D - 27% F.L. - Highly.
Bed Rock.		12.80 - 14.30	S _{2020/2575}		T.C.R - 93% R.Q.D - 85% F.L. - 5-8 rpm.
			UCS - 9980 psi		

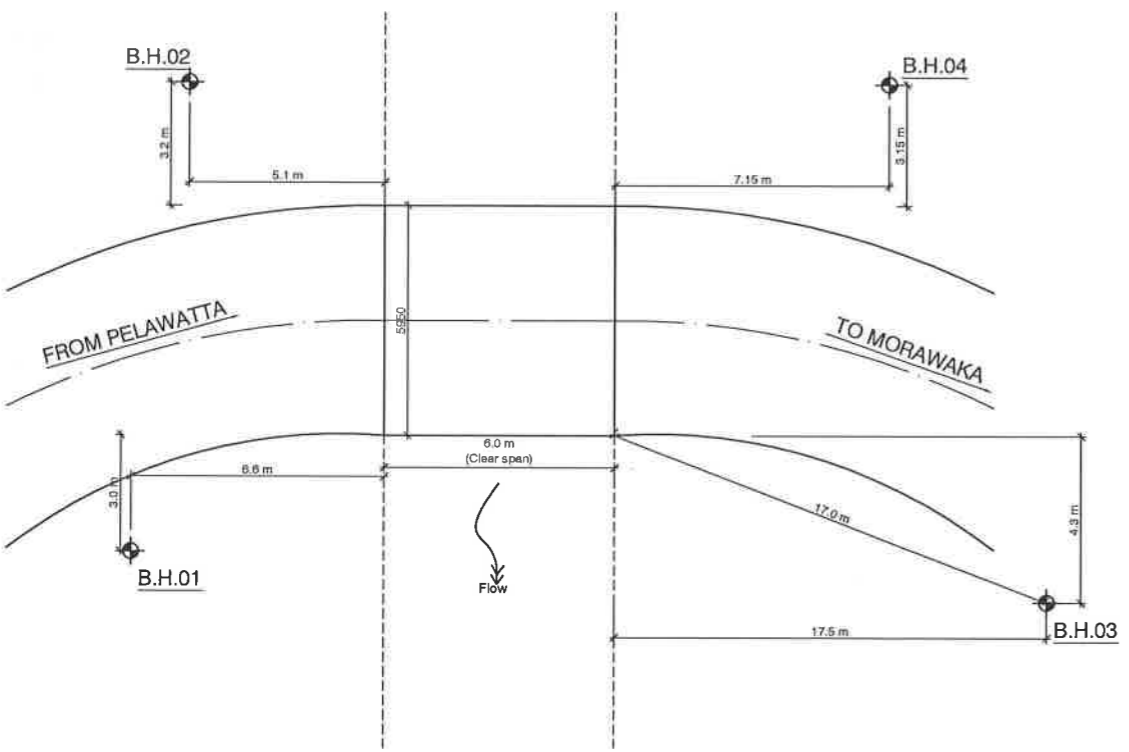

SITE SKETCH
(Not Scale)

TENDER ISSUE
NOT FOR CONSTRUCTION

PELAWATTA - KANKOTIYAWATTA - THINIYAWALA - MORAWAKA ROAD. (B 363)
BRIDGE NO: 9/1 km (RE-CONSTRUCTION)

BORE HOLE LOGS & S.P.T VALUES

REV.	DESCRIPTION	BY	DATE

MINISTRY OF HIGHWAYS - SRI LANKA ROAD DEVELOPMENT AUTHORITY		BRIDGE DESIGNS OFFICE *MAGANEKUMA MAHAMEDURA* BATTARAMULLA
DESIGNED : K.K.D.N.J. Ranawera DHAWN : Suranga Pradeep CHECKED : FILE NO. : WP-90 DRG. NO. WP/B/1494/1B	SENIOR ENGINEER - DESIGNS ADDITIONAL DIRECTOR - BRIDGE DESIGNS	DEPUTY DIRECTOR GENERAL (S.D.) ADDITIONAL DIRECTOR GENERAL (E.S.) FOR DIRECTOR GENERAL

FROM PELAWATTA

TO MORAWAKA

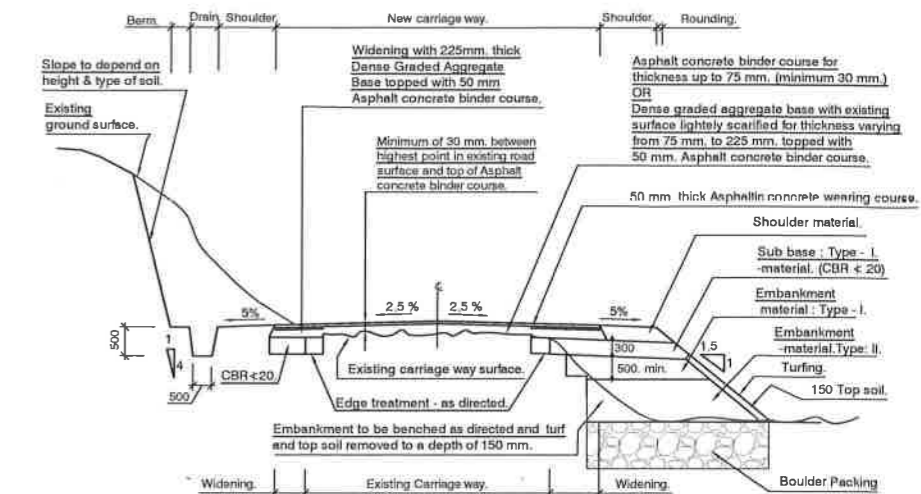
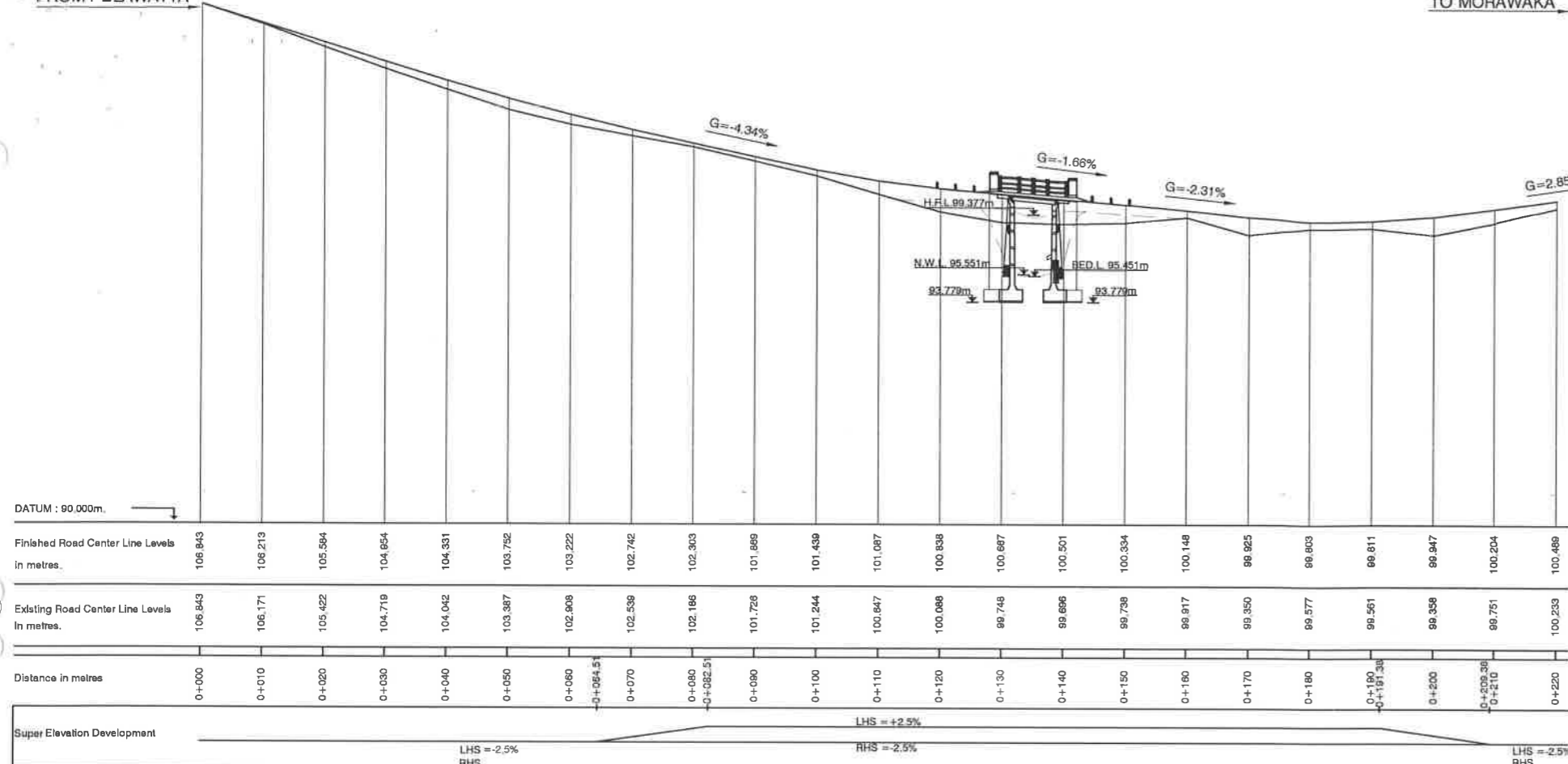

NOTES :

- For overlay thickness varying from 75 - 225 mm, use dense graded aggregate base with existing surface lightly scarified.
- For overlay thickness less than 75mm, use dense graded aggregate base of thickness 225 mm, with existing base scarified.
- Where the widened carriage way merges to the existing carriage way and the overlay is < 75 mm. Asphalt concrete binder course to be used with suitable overlap between the two bases with existing surface lightly scarified.

TYPICAL ROAD SECTION WIDENING : CUTTING & FILLING. NOT TO SCALE

LONGITUDINAL SECTION

Scale: Vertical 1:100 Horizontal 1:500

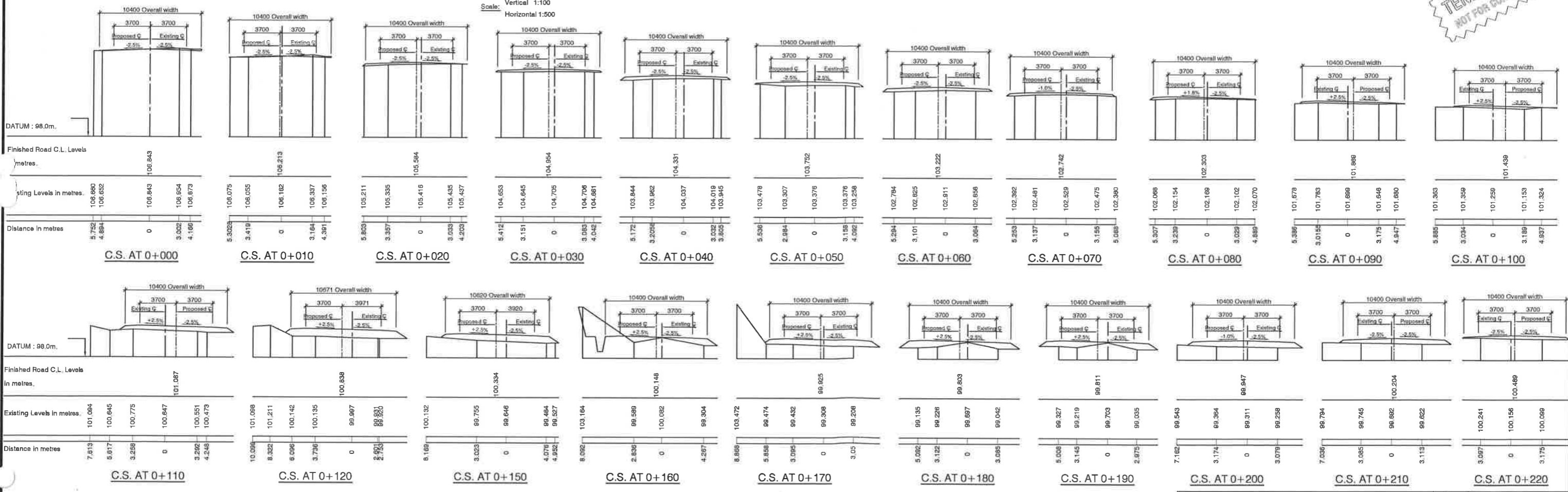

PELAWATTA - KANKOTIYAWATTA - THINIYAWALA - MORAWAKA ROAD. (B 363)
BRIDGE NO: 9/1 km (RE-CONSTRUCTION)

L.S. & CROSS SECTIONS

REV.	DESCRIPTION	BY	DATE

MINISTRY OF HIGHWAYS - SRI LANKA
ROAD DEVELOPMENT AUTHORITY

DESIGNED : *K.K.D.N.J. Ranawera*
 DRAWN : *Suranga Pradeep*
 CHECKED :
 FILE NO. : **WP-80**
 DRG. NO. **WP/B/1494/2**

SENIOR ENGINEER - DESIGNS
 ADDITIONAL DIRECTOR - BRIDGE DESIGNS

BRIDGE DESIGNS OFFICE
 'MAGANEGUMA MAHAMEDURA'
 BATTARAMULLA

DEPUTY DIRECTOR GENERAL (S.D.)
 ADDITIONAL DIRECTOR GENERAL (E.S.)
 FOR DIRECTOR GENERAL

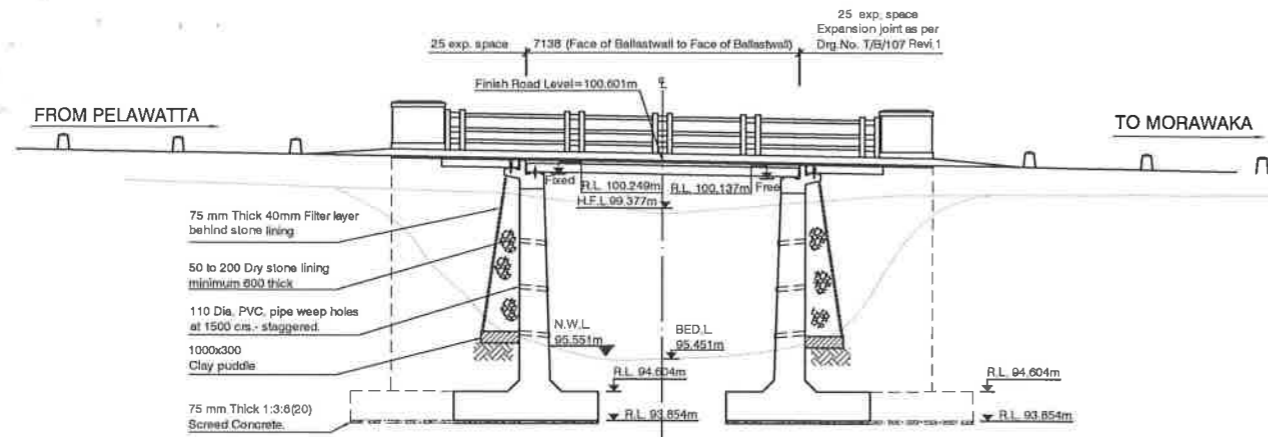

Datum : R.L.90.0 m

Distance in metres	0+120	0+130	0+134	0+140	0+150
Finished road center line levels in meters	100.838	100.867	100.801	100.484	100.334
Existing road center line Levels in meters	100.069	99.748	99.211	99.890	98.738

LONGITUDINAL SECTION
Scale 1:100

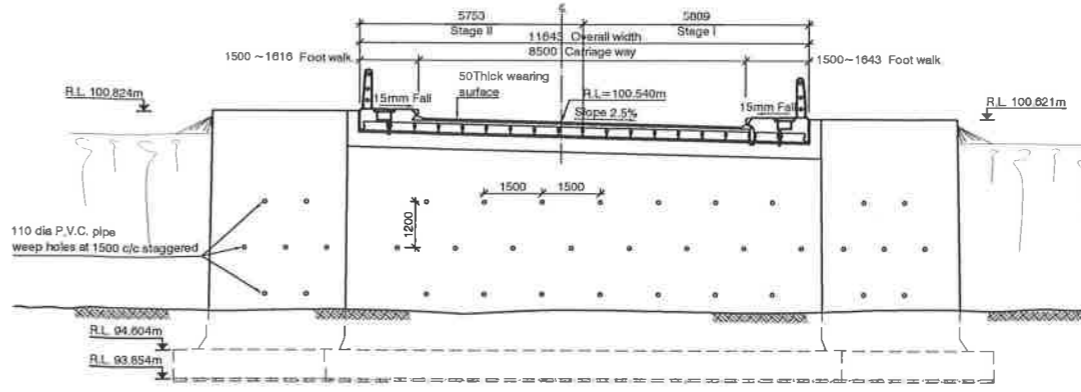

ELEVATION OF ABUTMENT (MORAWAKA END)
Scale 1:100

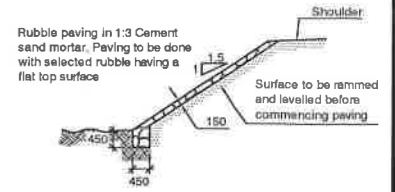

DETAIL OF RUBBLE PAVING AT WING WALL
Scale: 1 : 100

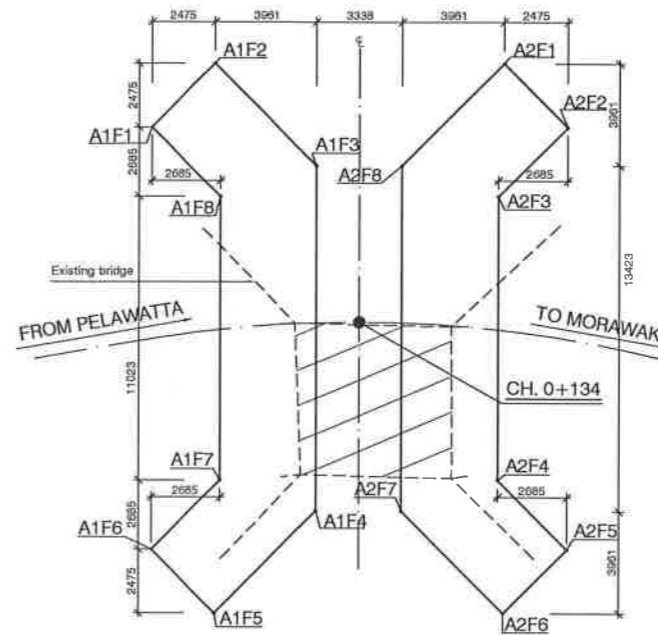

SETTING OUT DETAIL OF BRIDGE FOUNDATION
Scale 1:150

CO - ORDINATES FOR SETTING OUT OF FOUNDATION

POSITION	CO - ORDINATES(m)	
	NORTHING	EASTING
A1F1	1017.5990	1004.5042
A1F2	1017.9232	1007.9892
A1F3	1014.1416	1008.3400
A1F4	1007.1002	1016.8213
A1F5	1007.4510	1020.6029
A1F8	1003.9560	1020.9261
A1F7	1003.4488	1015.3490
A1F6	1012.0227	1005.0215
A2F1	1005.4522	997.8355
A2F2	1008.9372	997.3122
A2F3	1009.4546	1002.8804
A2F4	1000.8805	1013.2198
A2F5	995.3033	1013.7342
A2F6	994.9800	1010.2492
A2F7	996.7616	1009.8984
A2F8	1005.8030	1001.4171

NOTES: GENERAL.

- All dimensions are in millimetres unless otherwise stated.
- This drawing to be read in conjunction with drawing Nos WP/B/1494/1, 1A, 1B, 2, 4 to 6 and standard specifications for Construction and Maintenance of Roads and Bridges.
- Dimensions shall not be obtained by scaling.
- Any discrepancies in the contract drawings shall be referred to the engineer for revisions before proceeding with work.
- Any setting out dimensions shown on drawing shall be verified.
- All workmanship and materials are to be accord with the requirements of the specifications and by laws of the authority.
- Wing wall lengths are to be adjusted at site to suit the variation in site condition during construction.
- Additional weep holes are to be provided if necessary to suit site condition.
- Design Bearing pressure - Foundation of abutment & wing wall - 270 kN/m²

DRAWING INDEX:

DRAWING NO	TITLE
WP/B/1494/1	Site plan
WP/B/1494/1A	Acquisition plan
WP/B/1494/1B	Borehole logs & S.P.T. Values
WP/B/1494/2	LS & CSS
WP/B/1494/3	General plan
WP/B/1494/4	General Details of abutment & wing walls
WP/B/1494/5	R.F. Details of abutment wing walls
WP/B/1494/6	Details of Deck

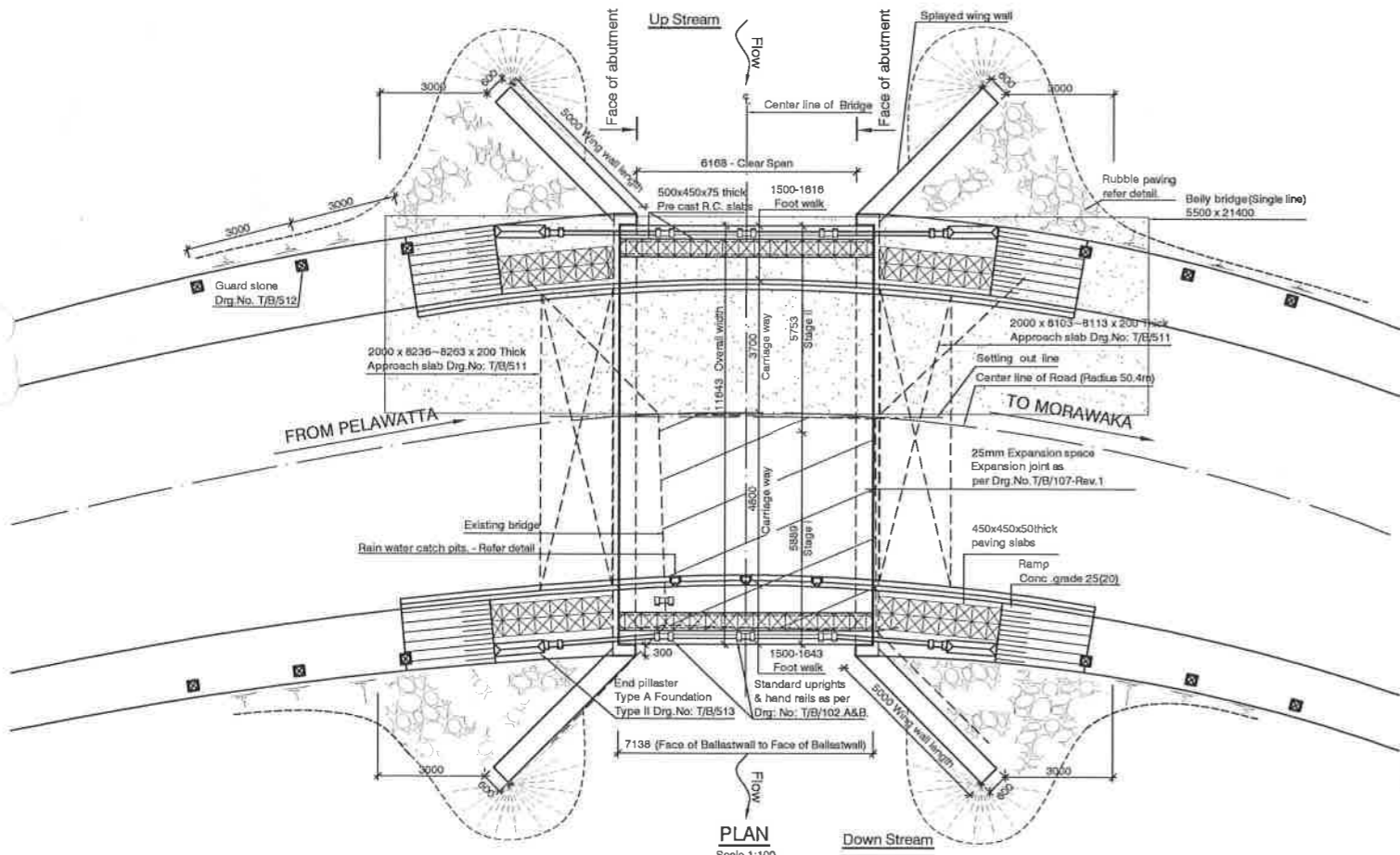

PLAN
Scale 1:100

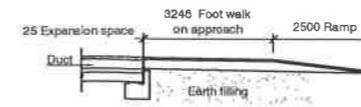

SECTION X-X

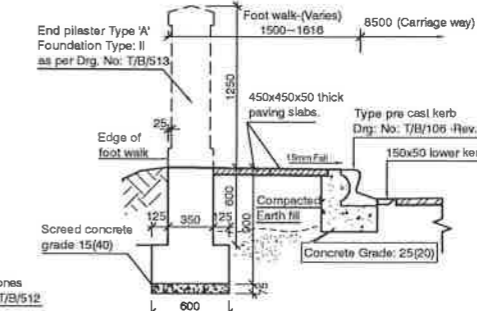

SECTION Y-Y AT FOOTWALK ON APPROACHES
Scale: 1 : 30



DETAILS OF FOOTWALK ON APPROACHES
Scale 1:100

TENDER ISSUE
NOT FOR CONSTRUCTION

PELAWATTA - KANKOTIYAWATTA - THINIYAWALA - MORAWAKA ROAD. (B 363)
BRIDGE NO: 9/1 km (RE-CONSTRUCTION)

GENERAL PLAN

REV.	DESCRIPTION	BY	DATE

MINISTRY OF HIGHWAYS - SRI LANKA ROAD DEVELOPMENT AUTHORITY			BRIDGE DESIGNS OFFICE *MAGANEGUMA MAHAMEDURA* BATTARAMULLA
DESIGNED : K.K.D.N.J. Ranawansa	SENIOR ENGINEER - DESIGNS		DEPUTY DIRECTOR GENERAL (S.D.)
DRAWN : Suranga Pradeep	ADDITIONAL DIRECTOR - BRIDGE DESIGNS	ADDITIONAL DIRECTOR GENERAL (E.S.) FOR DIRECTOR GENERAL	
CHECKED : WP-90	DRG. NO. WP/B/1494/3	8	DATE:

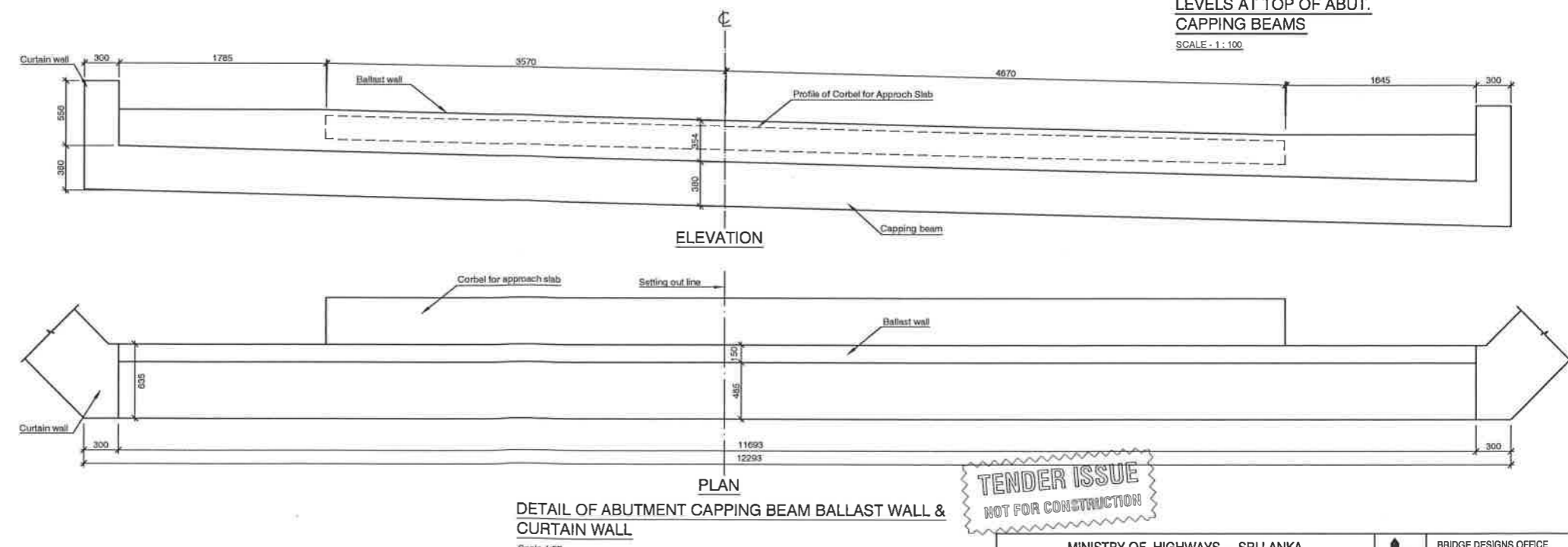
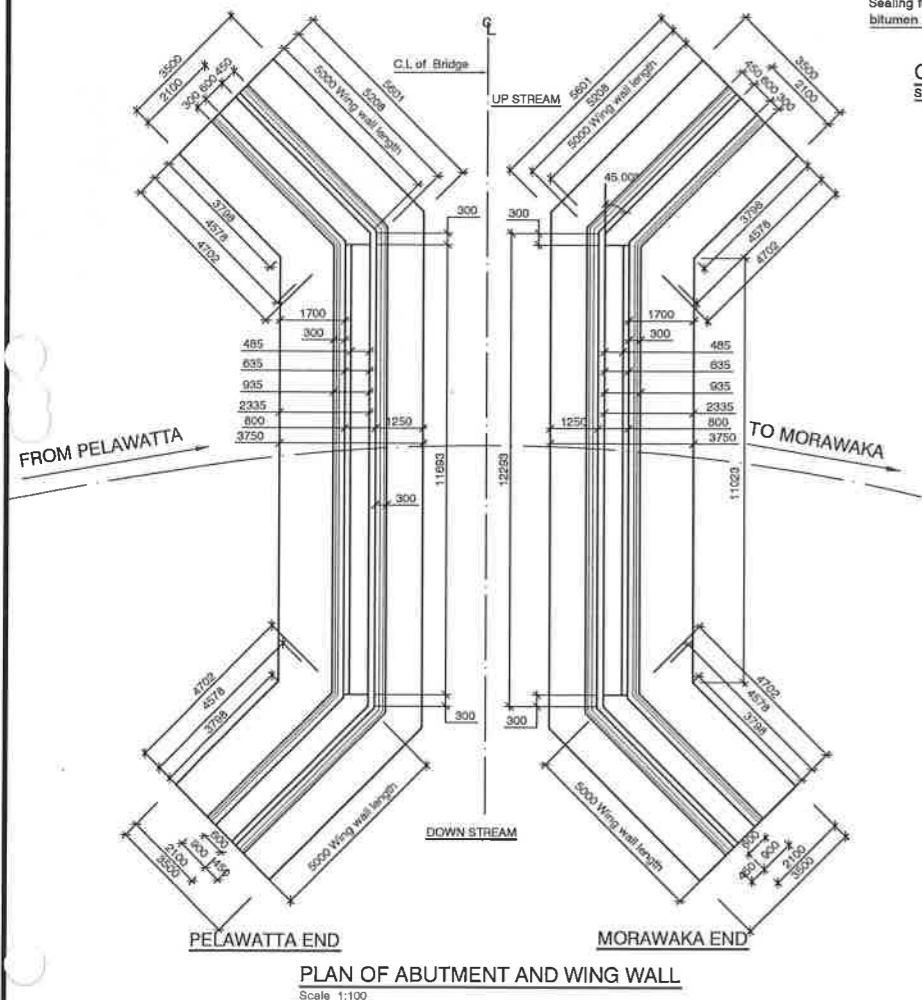
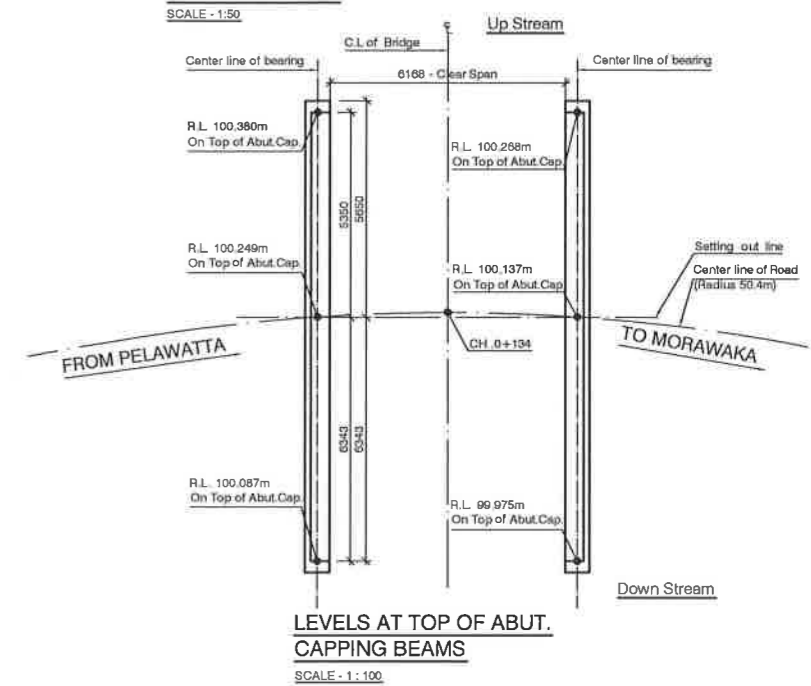
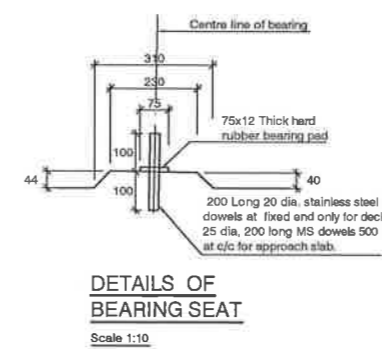
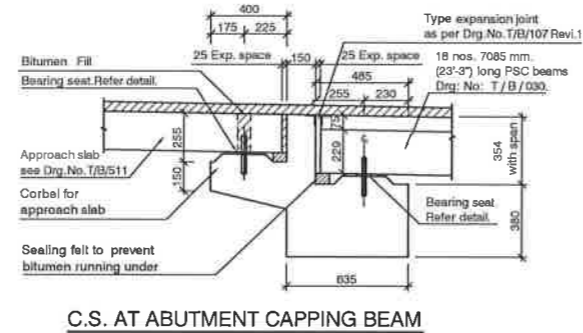
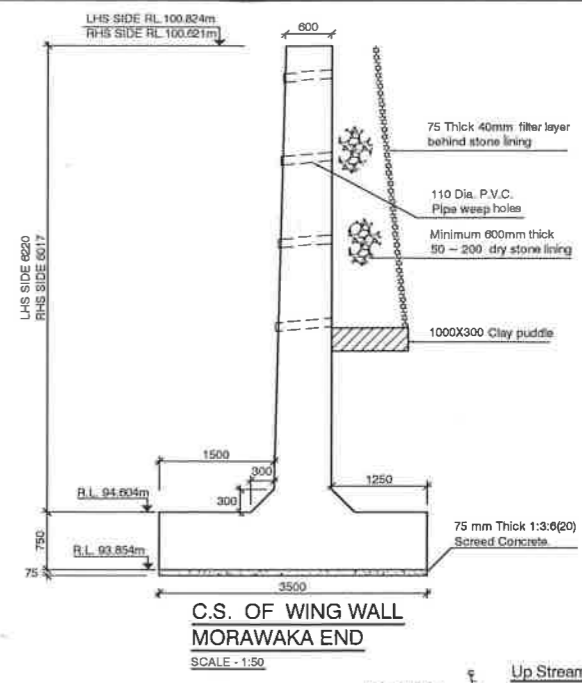
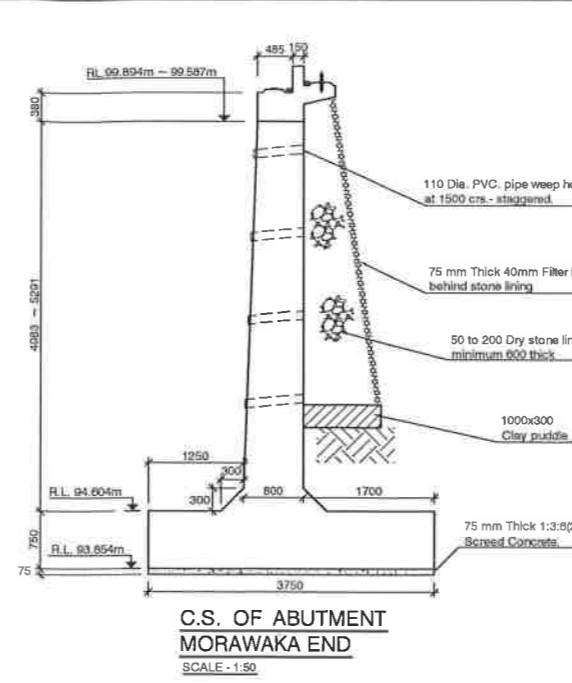
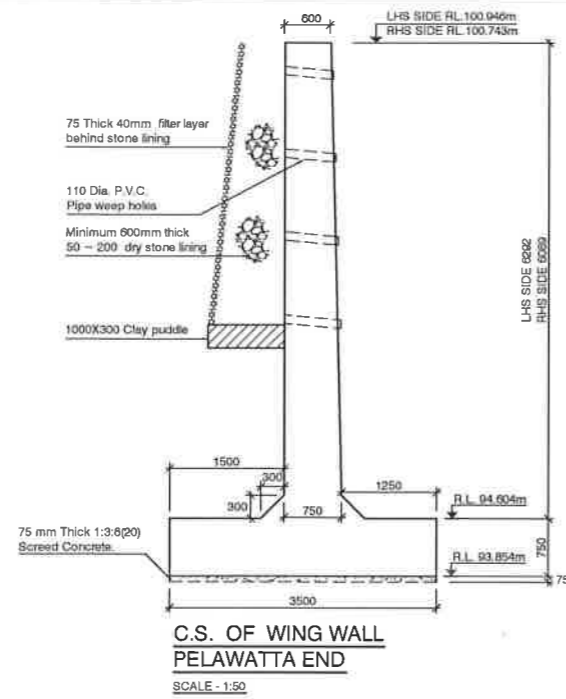
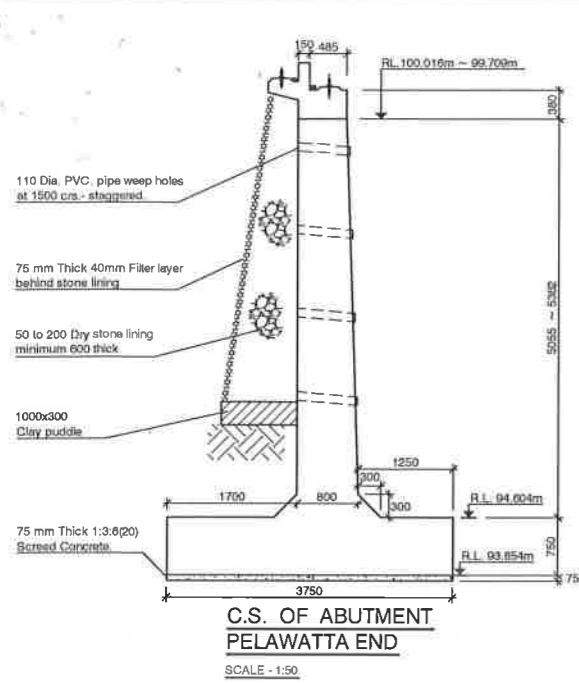

TENDER ISSUE
NOT FOR CONSTRUCTION

PELAWATTA - KANKOTIYAWATTA - THINIYAWALA - MORAWAKA ROAD. (B 363)
BRIDGE NO: 9/1 km (RE-CONSTRUCTION)

GENERAL DETAILS OF ABUTMENT & WING WALL

REV.	DESCRIPTION	BY	DATE

MINISTRY OF HIGHWAYS - SRI LANKA
ROAD DEVELOPMENT AUTHORITY

DESIGNED : *K.K.D.N.J. Ranawera*
DRAWN : *Suranga Pradeep*
CHECKED :
FILE NO. : *W/P-30*
DRG. NO. *WP/B/1494/4*

SENIOR ENGINEER - DESIGNS
ADDITIONAL DIRECTOR - BRIDGE DESIGNS

DEPUTY DIRECTOR GENERAL (S.I.)
ADDITIONAL DIRECTOR GENERAL (E.S.) FOR DIRECTOR GENERAL

BRIDGE DESIGNS OFFICE
"MAGANEGUMA MAHAMEDURA"
BATTARAMULLA

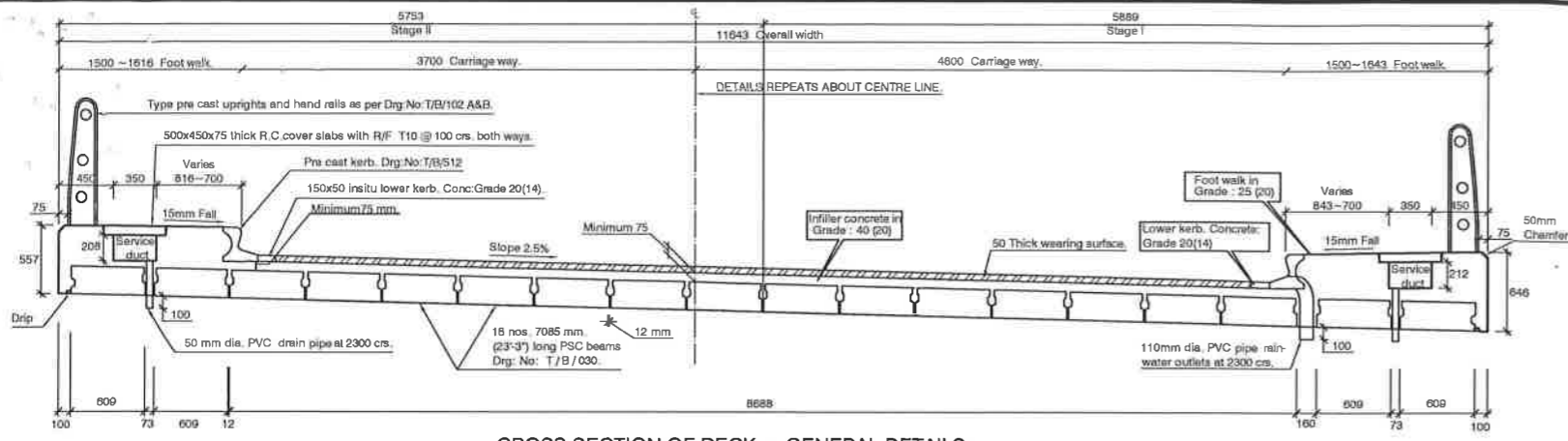

CROSS SECTION OF DECK - GENERAL DETAILS
Scale 1:30

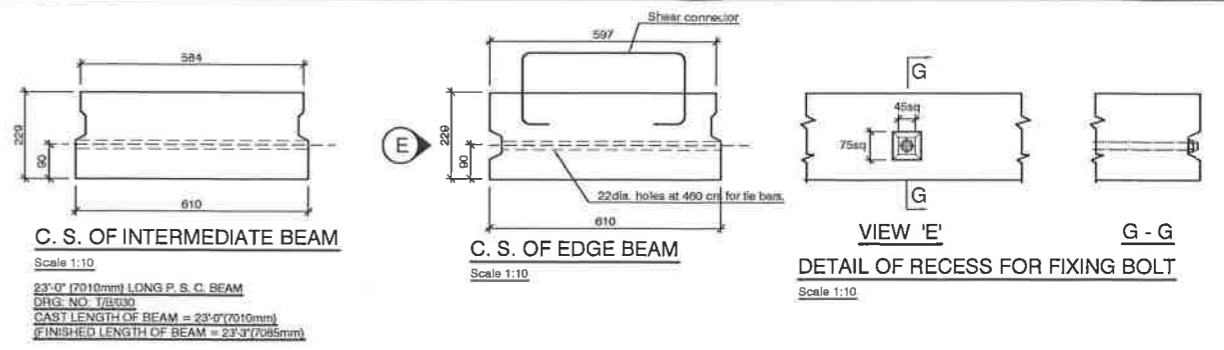

C.S. OF INTERMEDIATE BEAM
Scale 1:10
23'0" (7010mm) LONG P. S. C. BEAM
DRG. NO. T/RS/03
CAST LENGTH OF BEAM = 23'0" (7010mm)
FINISHED LENGTH OF BEAM = 23'3" (7045mm)

C.S. OF EDGE BEAM
Scale 1:10

VIEW 'E' G-G
DETAIL OF RECESS FOR FIXING BOLT
Scale 1:10

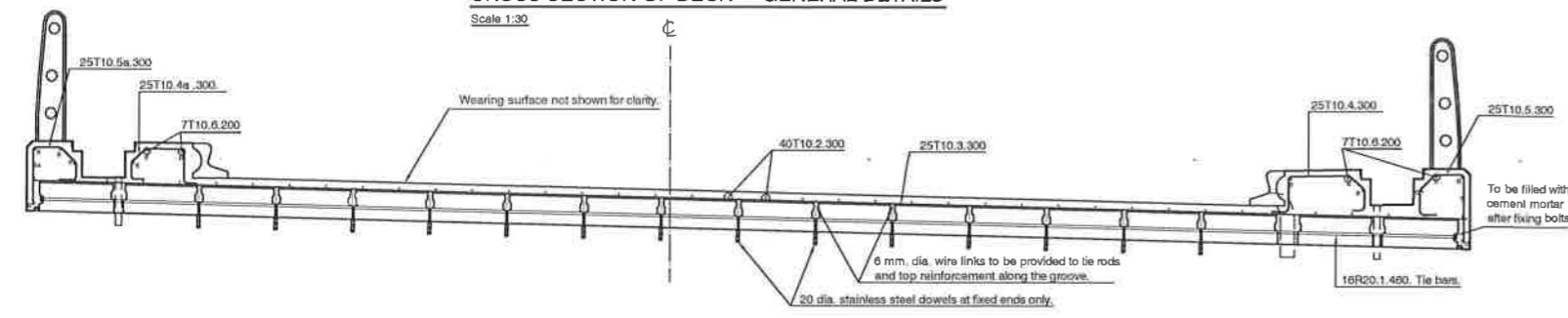

CROSS SECTION OF DECK - R/F DETAILS
Scale 1:30

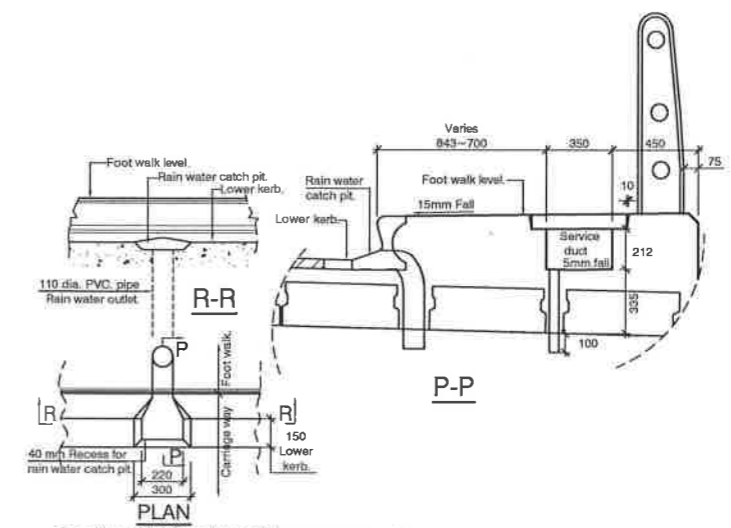

DETAIL OF RAIN WATER CATCH PIT.
Scale 1:20

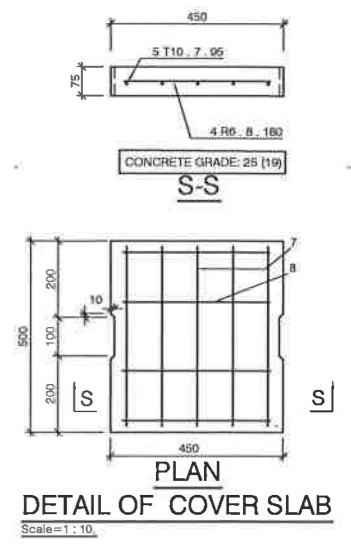

DETAIL OF COVER SLAB
Scale 1:10

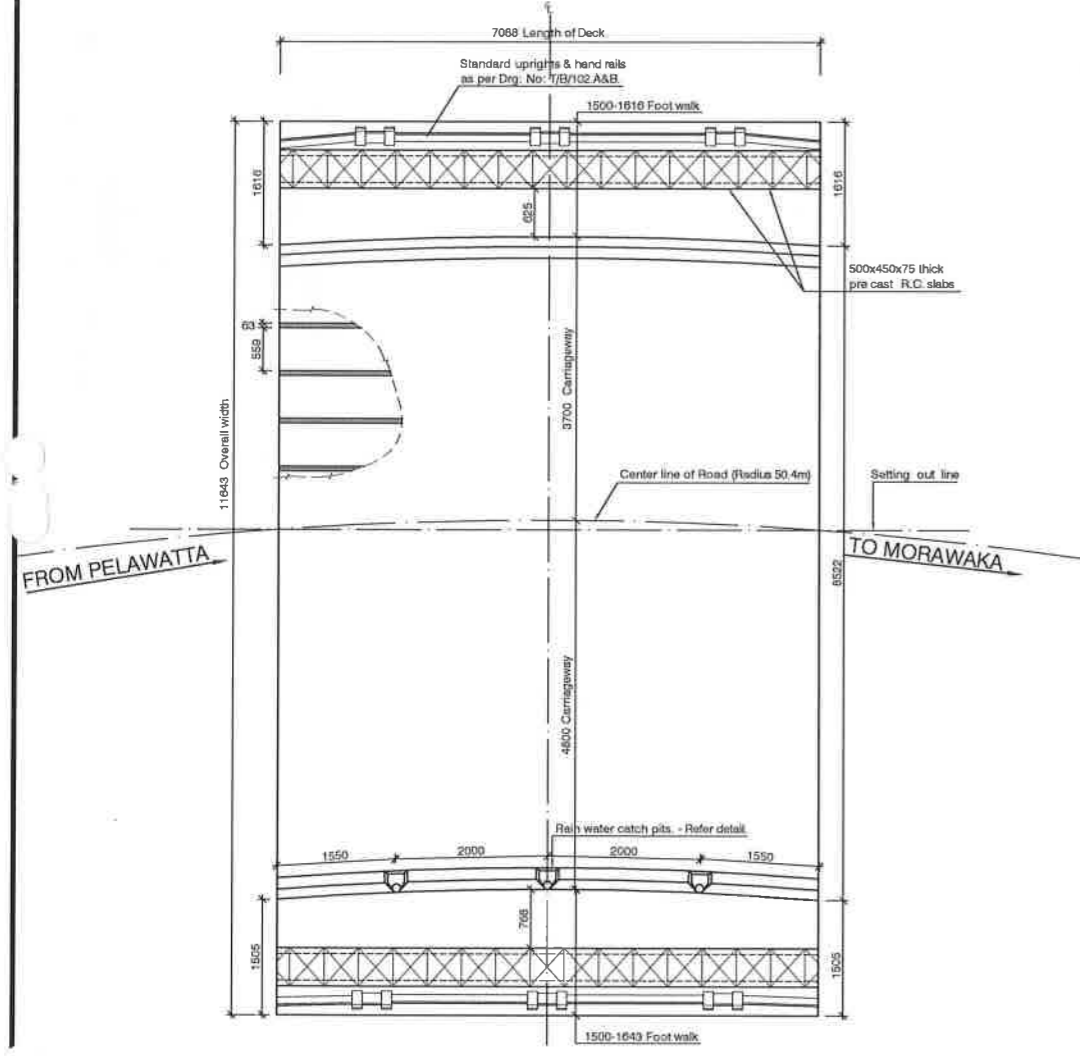

PLAN OF DECK.
Scale 1:50

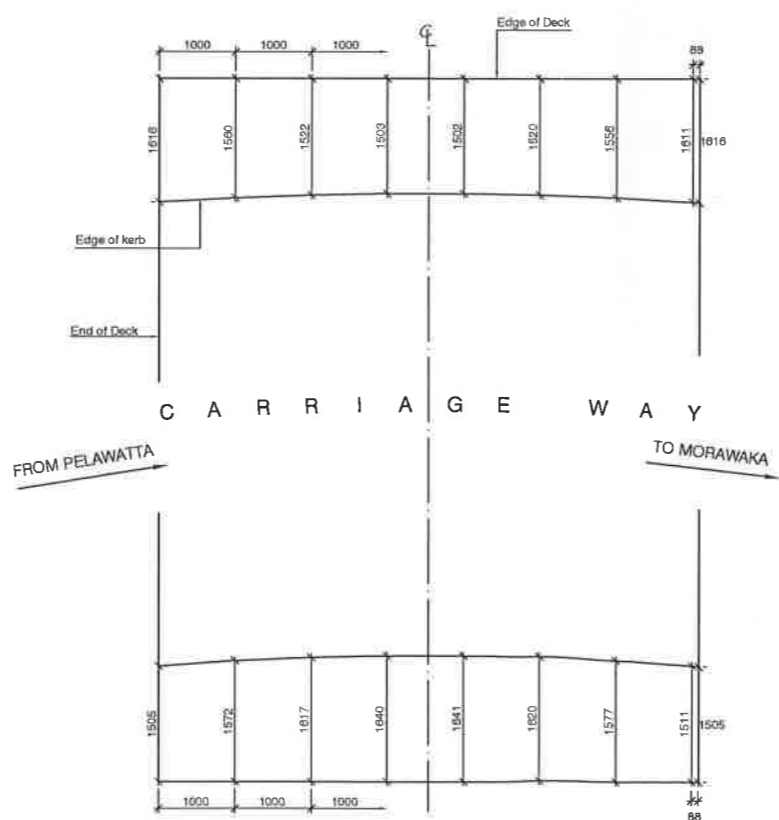

PLAN OF FOOT WALK SHOWING SETTING OUT DETAILS OF KERB ON DECK
Scale 1:50

SCHEDULE OF REINFORCEMENT									
Member	Bar Mark	Type & Size	Noe of Mbrs	No. of Bars in each	Total No	Length of each Bar in (mm)	Total Length in (m)	Weight in (kg)	Bending.
Deck Slab	1	R20	1	16	16	11427	182.8	451.8	① 11427
	2	T10	1	40	40	6965	279.4	172.4	② 6965
	3	T10	1	25	25	11587	289.7	178.7	③ 11587
Foot walk	4	T10	1	25	25	TL	32.1	19.8	④ TL
	4a	T10	1	25	25	TL	30.7	18.9	④ TL
	5	T10	1	25	25	1250	31.3	19.3	⑤ 1250
	5a	T10	1	25	25	1180	29.0	17.9	⑤ 1180
Cover slab R/F for 1 no	8	T10	1	5	5	400	2.0	1.2	⑥ 400
	9	R6	1	4	4	350	1.4	0.3	⑦ 350

NOTES: REINFORCEMENT.

- All bars marked 'R' shall be hot rolled mild steel plain bars of yield strength not less than 250 N/mm².
- All bars marked 'T' shall be high yield deformed bars of yield strength not less than 400 N/mm².
- The bars shall be bent and hooked in accordance with BS-4466:1999.
- Bars of cut length larger than the supplied length should be spliced with a lap length = 55 x bar dia. and splicing should be staggered.
- Type of form work for foundation slab - rough.
- Clear cover to reinforcements (outside of stirrups or ties) shall be:

	Formed & exposed	Not formed
Foundation	75	75
Abutment & Wingwall	50	50
Capping Beam	50	50

TENDER ISSUE
NOT FOR CONSTRUCTION

PELAWATTA - KANKOTIYAWATTA - THINIYAWALA - MORAWAKA ROAD. (B 363)
BRIDGE NO: 9/1 km (RE-CONSTRUCTION)

DETAILS OF DECK

REV.	DESCRIPTION	BY	DATE

MINISTRY OF HIGHWAYS - SRI LANKA ROAD DEVELOPMENT AUTHORITY		BRIDGE DESIGNS OFFICE "MAGANEGUMA MAHAMEDURA" BATTARAMULLA
DESIGNED : K.K.D.N.J. Ranawera	SENIOR ENGINEER - DESIGNS	
DRAWN : Suranga Pradeep	ADDITIONAL DIRECTOR - BRIDGE DESIGNS	ADDITIONAL DIRECTOR GENERAL (E.S.) FOR DIRECTOR GENERAL
CHECKED :	DRG. NO. WP/B/1494/6	DATE:

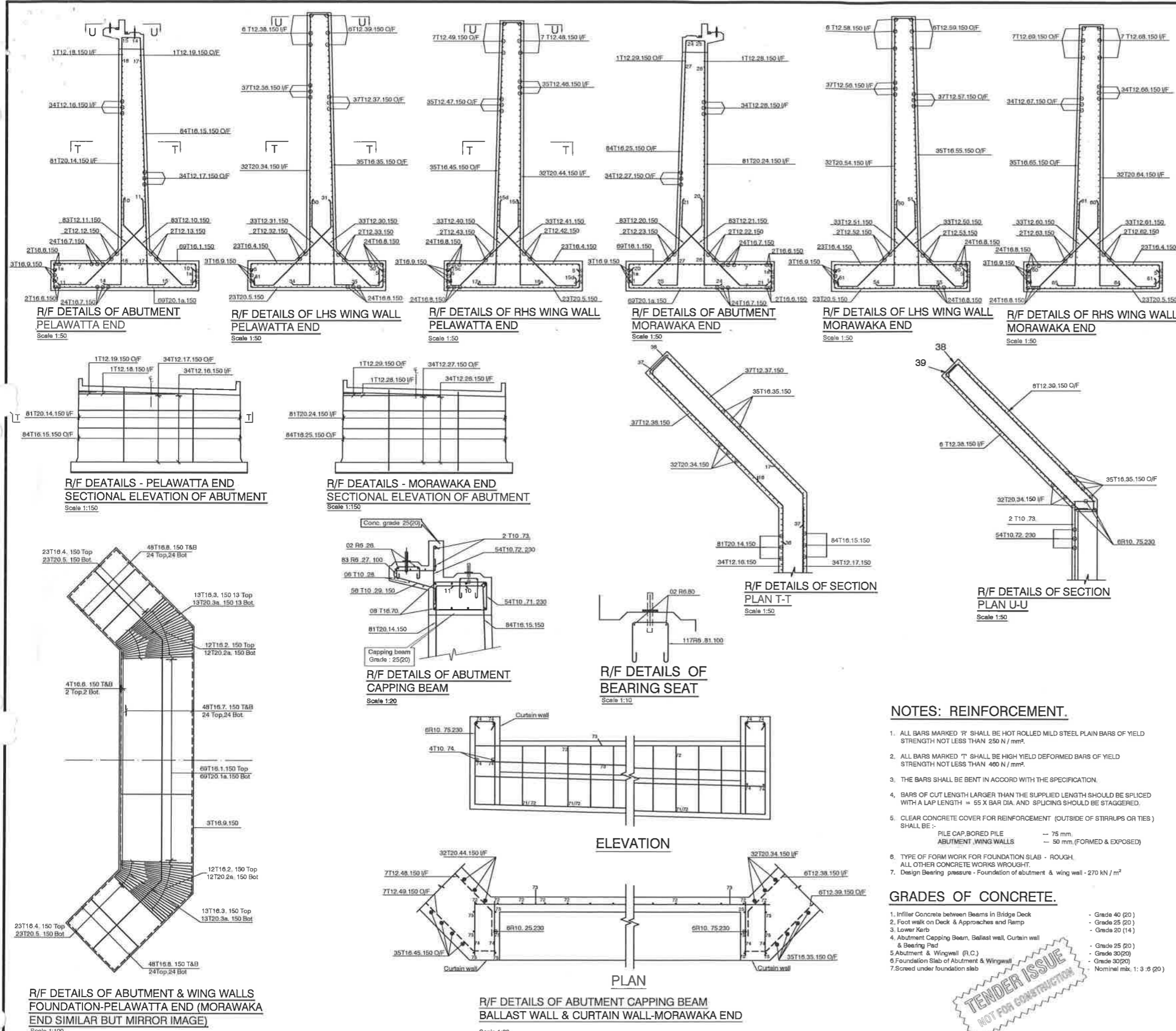

SCHEDULE OF REINFORCEMENT

Member.	Bar mark	Type and Size	No. of mtrs.	No. of bars in each.	Total No.	Length of each bar in m.	Total length in m.	Weight in kg.	Bending	
Abutment & Wingwall Foundation Pelawatta End Morawaka End	1	T16	2	89	138	4700	648.0	1024.8	550	
	1a	T20	2	89	138	4700	648.5	1002.0	550	
	2	T16	2	12x2	48	TL	137.5	217.3	mini max x 2241 2389	
	2a	T20	2	12x2	48	TL	137.5	339.7	550	
	3	T16	2	13x2	52	TL	212.5	335.8	550	
	3a	T20	2	13x2	52	TL	212.5	524.9	550	
	4	T16	2	23x2	92	4450	409.4	649.9	550	
	5	T20	2	23x2	92	4450	409.4	1011.2	550	
	6	T16	2	4	8	TL	87.9	138.9	550	
	7	T16	2	48	96	TL	1318.4	2083.0	550	
Abutment Stem Pelawatta End	8	T16	2	48	96	TL	545.4	861.7	550	
	9	T16	2	3	6	40644	297.9	470.6	550	
	10	T12	1	83	83	3440	285.5	254.1	550	
	11	T12	1	83	83	3410	283.0	251.9	550	
	12	T12	1	2	2	23288	46.5	41.4	550	
	13	T12	1	2	2	24334	48.7	43.3	550	
	14	T20	1	81	81	TL	559.1	1381.0	550	
	15	T16	1	84	84	TL	580.1	918.5	550	
	16	T12	1	34	34	13227	449.7	400.2	550	
	17	T12	1	34	34	TL	483.0	412.1	550	
Abutment Stem Morawaka End	18	T12	1	1	1	6395	6.4	5.7	550	
	19	T12	1	1	1	3370	3.4	3.0	550	
	20	T12	1	83	83	3440	285.5	254.1	550	
	21	T12	1	83	83	3410	283.0	251.9	550	
	22	T12	1	2	2	23288	46.5	41.4	550	
	23	T12	1	2	2	24334	48.7	43.3	550	
	24	T20	1	81	81	TL	552.6	1365.0	550	
	25	T16	1	84	84	TL	573.3	905.9	550	
	26	T12	1	34	34	13227	449.7	400.2	550	
	27	T12	1	34	34	TL	483.0	412.1	550	
Wingwall Pelawatta End LHS	28	T12	1	1	1	6395	6.4	5.7	550	
	29	T12	1	1	1	3370	3.4	3.0	550	
	30	T12	1	33	33	3400	112.2	99.9	550	
	31	T12	1	33	33	3381	111.6	99.3	550	
	32	T12	1	2	2	23288	46.5	41.4	550	
	33	T12	1	2	2	24334	48.7	43.3	550	
	34	T20	1	32	32	7696	248.3	808.3	550	
	35	T16	1	35	35	7999	259.5	425.8	550	
	36	T12	1	37	37	5612	207.6	184.8	550	
	37	T12	1	37	37	6180	228.7	203.5	550	
Wingwall Pelawatta End RHS	38	T12	1	6	6	5323	31.9	28.4	550	
	39	T12	1	6	6	5579	33.5	29.8	550	
	40	T12	1	33	33	3400	112.2	99.9	550	
	41	T12	1	33	33	3381	111.6	99.3	550	
	42	T12	1	2	2	23288	46.5	41.4	550	
	43	T12	1	2	2	24334	48.7	43.3	550	
	44	T20	1	32	32	7483	238.8	592.2	550	
	45	T16	1	35	35	7496	262.4	414.5	550	
	46	T12	1	35	35	5612	196.4	174.8	550	
	47	T12	1	35	35	6180	216.3	192.5	550	
Wingwall Morawaka End LHS	48	T12	1	7	7	5323	37.3	33.2	550	
	49	T12	1	7	7	5579	39.1	34.8	550	
	50	T12	1	33	33	3400	112.2	99.9	550	
	51	T12	1	33	33	3381	111.6	99.3	550	
	52	T12	1	2	2	23288	46.5	41.4	550	
	53	T12	1	2	2	24334	48.7	43.3	550	
	54	T20	1	32	32	7624	244.0	802.6	550	
	55	T16	1	35	35	7627	269.9	421.8	550	
	56	T12	1	37	37	5612	207.6	184.8	550	
	57	T12	1	37	37	6180	228.7	203.5	550	
Wingwall Morawaka End RHS	58	T12	1	6	6	5323	31.9	28.4	550	
	59	T12	1	6	6	5579	33.5	29.8	550	
	60	T12	1	33	33	3400	112.2	99.9	550	
	61	T12	1	33	33	3381	111.6	99.3	550	
	62	T12	1	2	2	23288	46.5	41.4	550	
	63	T12	1	2	2	24334	48.7	43.3	550	
	64	T20	1	32	32	7421	237.5	586.6	550	
	65	T16	1	35	35	7424	259.8	410.5	550	
	66	T12	1	34	34	5012	190.8	169.8	550	
	67	T12	1	34	34	6180	210.1	167.0	550	
Capping beam, ballast wall	68	T12	2	7	14	5323	74.5	66.3	550	
	69	T12	2	7	14	5579	78.1	69.5	550	
	70	T16	2	8	16	12795	204.7	323.5	550	
	71	T10	2	54	108	1830	176.0	108.6	550	
	72	T10	2	54	108	TL	81.8	50.3	550	
	73	T10	2	2	4	12195	48.8	30.1	550	
	74	T10	2	4x2	16	535	8.6	5.3	550	
	75	T10	2	6x2	24	1960	47.0	29.0	550	
	76	R6	2	2	4	8363	33.5	7.4	550	
	77	R8	2	83	166	550	91.3	20.3	550	
Seat for approach slab	78	T10	2	6	12	8163	69.0	60.4	550	
	79	T10	2	58	112	1300	145.8	89.8	550	
	80	R6	2	2	4	11793	47.2	10.5	550	
	81	R6	2	117	234	550	128.7	26.6	550	
	Bearing plinth									550
										550
										550
										550
										550
										550
									550	
									550	
									550	
									550	

NOTES: REINFORCEMENT.

- ALL BARS MARKED 'R' SHALL BE HOT ROLLED MILD STEEL PLAIN BARS OF YIELD STRENGTH NOT LESS THAN 250 N/mm².
- ALL BARS MARKED 'T' SHALL BE HIGH YIELD DEFORMED BARS OF YIELD STRENGTH NOT LESS THAN 460 N/mm².
- THE BARS SHALL BE BENT IN ACCORD WITH THE SPECIFICATION.
- BARS OF CUT LENGTH LARGER THAN THE SUPPLIED LENGTH SHOULD BE SPLICED WITH A LAP LENGTH = 55 X BAR DIA. AND SPLICING SHOULD BE STAGGERED.
- CLEAR CONCRETE COVER FOR REINFORCEMENT (OUTSIDE OF STIRRUPS OR TIES) SHALL BE :-
PILE CAP, BORED PILE - 75 mm.
ABUTMENT, WING WALLS - 50 mm, (FORMED & EXPOSED)
- TYPE OF FORM WORK FOR FOUNDATION SLAB - ROUGH.
ALL OTHER CONCRETE WORKS WROUGHT.
- Design Bearing pressure - Foundation of abutment & wing wall - 270 kN/m²

GRADES OF CONCRETE.

- Infiller Concrete between Beams in Bridge Deck - Grade 40 (20)
- Foot walk on Deck & Approaches and Ramp - Grade 25 (20)
- Lower Kerb - Grade 20 (14)
- Abutment Capping Beam, Ballast wall, Curtain wall & Bearing Pad - Grade 25 (20)
- Abutment & Wingwall (R.C.) - Grade 30(20)
- Foundation Slab of Abutment & Wingwall - Grade 30(20)
- Screed under foundation slab - Nominal mix, 1:3:6 (20)

NOTE: This schedule is indicative only. The contractor shall be responsible for producing his own schedule.

PELAWATTA - KANKOTIYAWATTA - THINIYAWALA - MORAWAKA ROAD. (B 363)
BRIDGE NO: 9/1 km (RE-CONSTRUCTION)

R/F DETAILS OF ABUTMENT & WING WALL

REV.	DESCRIPTION	BY	DATE

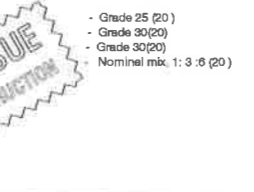

MINISTRY OF HIGHWAYS - SRI LANKA
ROAD DEVELOPMENT AUTHORITY

DESIGNED : **K.K.D.N.J. Ranawera**
 DRAWN : **Suranga Pradeep**
 CHECKED :
 FILE NO. : **WP-90**
 DRG. NO. **WP/B/1494/5**

SENIOR ENGINEER - DESIGNS
 ADDITIONAL DIRECTOR - BRIDGE DESIGNS
 DATE: _____

DEPUTY DIRECTOR GENERAL (S.D.)
 ADDITIONAL DIRECTOR GENERAL (E.S.)
 FOR DIRECTOR GENERAL